

# Pentrunder<sup>®</sup> MDU3



## TECHNICAL DATA

### MDU3-30

**Drill bit range**  
50 - 300 mm

**Spindle speed**  
200 - 1800 RPM

**Gear Ratio:**  
24:12 drop gear

**Max torque**  
60 Nm

### MDU3-60

**Drill bit range**  
80 - 600 mm

**Spindle speed**  
100 - 900 RPM

**Gear Ratio:**  
18:18 drop gear

**Max torque**  
120 Nm

### MDU3-100

**Drill bit range**  
125 - 1000 mm

**Spindle speed**  
50 - 450 RPM

**Gear Ratio:**  
12:24 drop gear

**Max torque**  
240 Nm



# MDU3 - TAKE YOUR

## Powerful and easy to handle

8 kW, water-cooled core drill motor

Available with either Manual feed or Pentruder's unique and patented fully integrated autofeed motor

## Integrated drive and control electronics

– no separate power pack, connect directly to 380 - 480V 50/60HZ 3-phase supply

## Motor RPM ratio 1:4

Exceptionally wide, electronically variable spindle speed range

## Proven, durable slip clutch for main motor

Electronical slip detection for best durability and long lifetime

## Patented integrated autofeed

Intuitive, easy to use autofeed - feed regulated with new-to-industry controls

## Built in display

Display showing angle of the spindle for easy and precise positioning of the rig

Display also shows: Amp, voltage, power, RPM, drill depth, etc





# DRILLING TO NEW DEPTHS

## Fast, easy and rigid mounting of MDU3 on CER2 carriage - patent pending

Patent pending for disconnect coupling

Core drill and carriage forms one rigid unit for best precision in the cut

Easy to mount

## Same track system as all other Pentrunder machines

Highest stability and best handling

Easy assembly on track

Equip your baseplate with wheels for easier maneuvering

## Low weight and well-balanced

MDU3 drill motor with Autofeed: 16.7 kg

CER2-AF drill carriage with Autofeed: 9.3 kg

## Quick disconnect drill bit adapters

Reduce the set up time, and if the drill bit would get stuck you can easily disconnect it and reverse the machine

## More information with the Pentrunder app

Mirroring of the display on the MDU3 so you can easily step back from the machine

Easy firmware updates with bluetooth directly from your phone to the MDU3

And much more



# MODULAR DRILL SYSTEM

## Drill motor

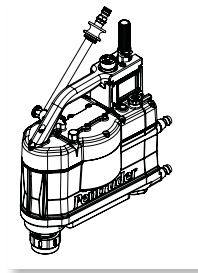

**MDU3-30**

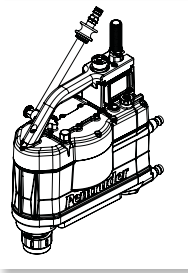

**MDU3-60**

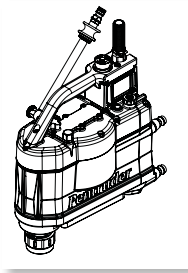

**MDU3-100**

## Drill carriage

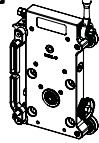

**CER2-AF**  
Drill carriage with  
integrated autofeed



**ERC1-87**  
Extension adapter for  
drilling over 600mm

**Launch  
in 2025**  
More modules  
will come

## Track system & Accessories

### TS Track



Back support for  
TS track

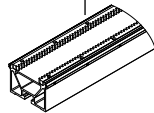

TS0.85: 0.85 m  
TS1.15: 1.15 m  
TS1.7: 1.7 m  
TS2.0: 2.0 m  
TS2.3: 2.3 m  
TS3.45: 3.45 m

### TCP Track column

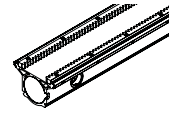

TCP Track column,  
swivels 360° degrees.  
Lengths: 0.3, 0.5, 0.85 and  
1.15 meters

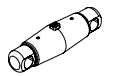

CC1 Joint,  
connect the TCP  
Track columns  
together to desired  
length.

### Accessories



**CEG-PDT1**,  
Pivoting head

### Base plate BTS-4



**BTS-4**  
For TS Track



**WT-BTS4**  
Wheels for BTS-4

### Base plate BTS-5



**BTS-5**  
For TS Track



**WT-BTS5-300**  
Wheels for BTS-5

### Track foot TF2S

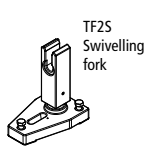

**TF2S**  
Swivelling  
fork



**TFAB**, Angle cutting  
attachment, to be used  
with TF2S

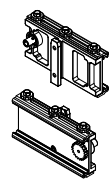

**CEL-TS**,  
Line and corner  
drilling carriage



**CT-CEL**,  
Back support for  
CEL-TS

### Base plate BFC1

BFC1, for TCP

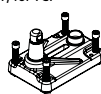

### Base plate BFC2

BFC2, for TCP



### Base plate BFC5

BFC5, for TCP

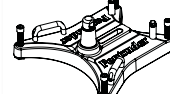

### Base plate BTC5

BTC5, for TCP

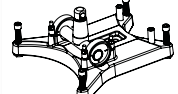

**Pentrunder®**  
CONCRETE CUTTING SYSTEMS

Pentrunder - designed and manufactured by:  
Tractive AB | Gjutargatan 54 | 781 70 Borlänge | Sweden  
[www.pentrunder.com](http://www.pentrunder.com) | [contact@pentrunder.com](mailto:contact@pentrunder.com)